



6 Glebe Avenue, Leeds, West Yorkshire, LS5 3HN

AVAILABLE 24th June 2026

A beautifully presented, warm and spacious three bedroom house in Kirkstall.

Fully furnished throughout, the property includes a large living room and separate kitchen, basement storage, a house bathroom, two large double bedrooms and a third room which is used as a study. Original wooden floors are retained throughout.

Glebe Avenue is a quiet cobbled street less than 0.2 miles from Headingley train station and 0.5 miles from supermarkets and gyms on Kirkstall Road. On street parking is available.

£1,200 Per month

www.fletcherprops.com

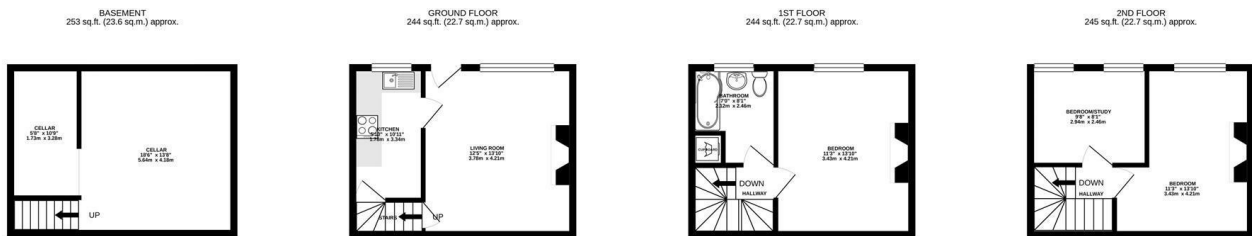

TOTAL FLOOR AREA : 987 sq.ft. (91.7 sq.m.) approx.

Whilst every attempt has been made to ensure the accuracy of the floorplan contained here, measurements of doors, windows, rooms and any other items are approximate and no responsibility is taken for any error, omission or mis-statement. This plan is for illustrative purposes only and should be used as such by any prospective purchaser. The services, systems and appliances shown have not been tested and no guarantee as to their operability or efficiency can be given.

Made with Metropix ©2020

