

32 Woodside Terrace, Leeds, West Yorkshire, LS4 2QT

AVAILABLE 1st July 2026

A refurbished, large and comfortable three bedroom house in Kirkstall.

A double-fronted end terrace, this house contains a large kitchen dining room with a separate living room. The house bathroom contains a bath and shower, whilst upstairs there is one large master bedroom, one regular double bedroom and one single bedroom. Externally there is a secure bike storage and a private terrace.

Woodside Terrace is a quiet residential street with on-street parking and easy access to supermarkets, gyms and restaurants on Kirkstall Road.

£1,195 Per month

www.fletcherprops.com

GROUND FLOOR 542 sq. ft.
(50.3 sq. m.)

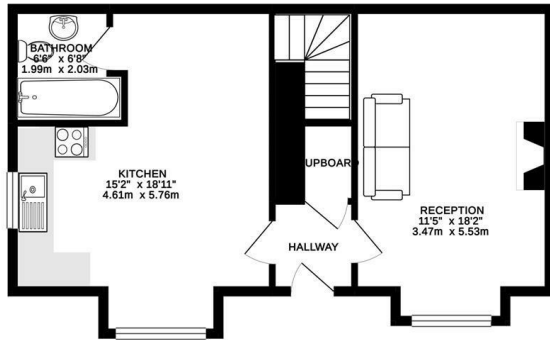

1ST FLOOR 379 sq. ft.
(35.2 sq. m.)

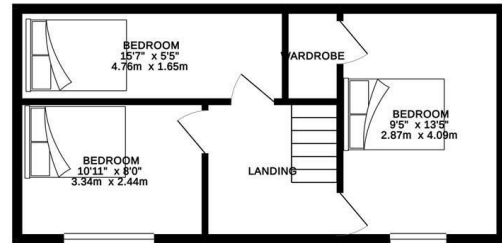

TOTAL FLOOR AREA : 920 sq. ft. (85.5 sq. m.) approx.

Whilst every attempt has been made to ensure the accuracy of the floorplan contained here, measurements of doors, windows, rooms and any other items are approximate and no responsibility is taken for any error, omission or mis-statement. This plan is for illustrative purposes only and should be used as such by any prospective purchaser. The services, systems and appliances shown have not been tested and no guarantee as to their operability or efficiency can be given.
Made with Metropix ©2019

Energy Efficiency Rating		Current	Potential
Very energy efficient - lower running costs			
(92 plus) A			
(81-91) B			
(69-80) C			
(55-68) D			
(39-54) E			
(21-38) F			
(1-20) G			
Not energy efficient - higher running costs			
England & Wales		EU Directive 2002/91/EC	

Environmental Impact (CO ₂) Rating		Current	Potential
Very environmentally friendly - lower CO ₂ emissions			
(92 plus) A			
(81-91) B			
(69-80) C			
(55-68) D			
(39-54) E			
(21-38) F			
(1-20) G			
Not environmentally friendly - higher CO ₂ emissions			
England & Wales		EU Directive 2002/91/EC	