



27 Green Hill Drive LS13 4JZ

A well presented three bedroom, semi detached property in Bramley.

Having recently benefitted from a full renovation throughout, this property includes recent new wiring and plumbing, as well as a new roof, new windows and new external doors.

A large reception room is located to the front, with an expansive and recently installed kitchen dining room to the rear. This area includes a recently installed log burner.

Upstairs, two double bedrooms are accompanied by a smaller guest room. The house bathroom has been extended and includes fully tiled walls.

The rear garden includes a wooden and stone patio. A large garage is accessed off the multi-vehicle driveway.

£295,000

- Newly Renovated
- New Roof
- New Windows
- Fully Rewired
- New Plumbing
- Modern Kitchen
- South Facing Garden
- Fully Insulated
- Half Boarded Loft
- New External Doors

GROUND FLOOR
542 sq.ft. (50.4 sq.m.) approx.

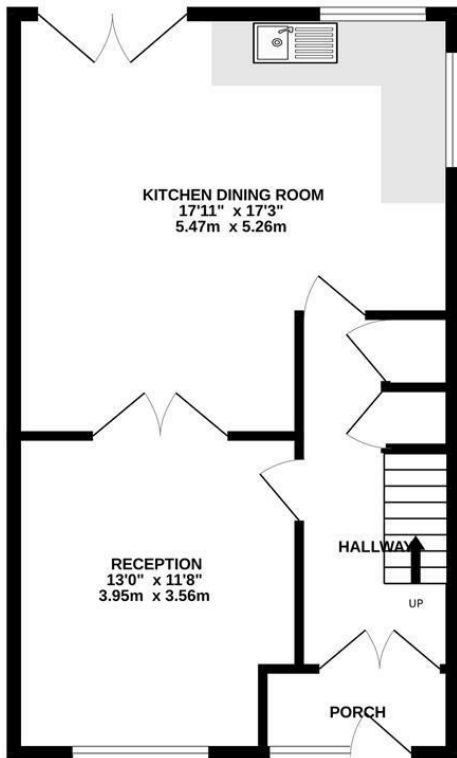

1ST FLOOR
442 sq.ft. (41.1 sq.m.) approx.

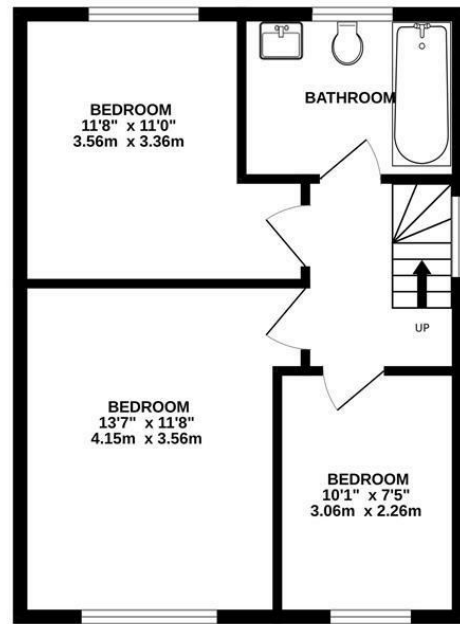

TOTAL FLOOR AREA : 985 sq.ft. (91.5 sq.m.) approx.

Whilst every attempt has been made to ensure the accuracy of the floorplan contained here, measurements of doors, windows, rooms and any other items are approximate and no responsibility is taken for any error, omission or mis-statement. This plan is for illustrative purposes only and should be used as such by any prospective purchaser. The services, systems and appliances shown have not been tested and no guarantee as to their operability or efficiency can be given.
Made with Metropix ©2026

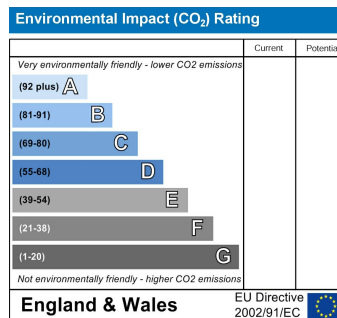
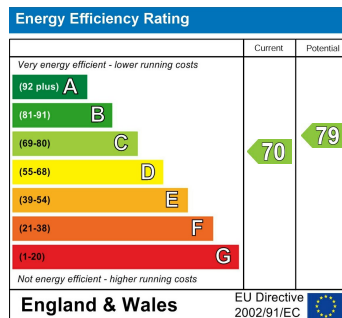

Tel: